



DICT
DEPARTMENT OF INFORMATION
AND COMMUNICATIONS TECHNOLOGY

2020

(2) How to install your PNPKI Certificates in your Windows Key store

PNPKI



Contents

Activate the Certificate Import Wizard	2
Start Following the Step by Step Guide.....	2
How to check if your Certificate was properly installed.....	4



How to install your certificate on to your windows key store

Activate the Certificate Import Wizard

1. Double click your certificate you want to install into windows.
2. On the [Certificate Import Wizard](#) click on [Next](#).



Start Following the Step by Step Guide

3. Type the password you set when you backed up the PNPKI certificate. Put a check on [Mark this key as exportable](#) and [Include all extended properties](#). The [Enable strong private key protection](#) is optional if you would not mind having to enter your password every time the certificates gets used. After that, click [Next](#).

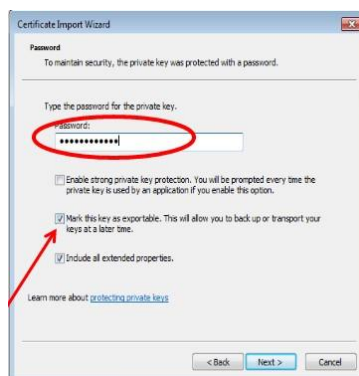

4. Choose “[Automatically select the certificate store based on the type of certificate](#)” then click [Next](#), then [Finish](#).

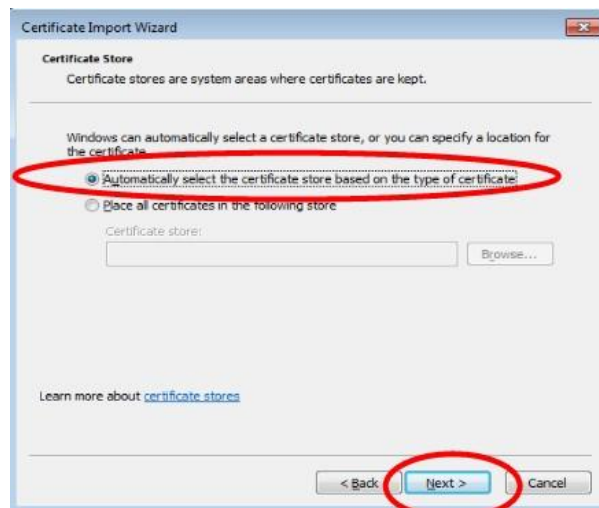

5. A notification will appear indicating you have successfully imported your certificate to the windows key store will appear. Click on [OK](#) to close



How to check if your Certificate was properly installed

6. Press the [Windows Key and the letter R](#) simultaneously

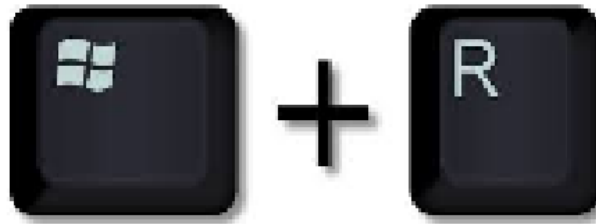

7. Type the command [certmgr.msc](#) on the [Open](#) field

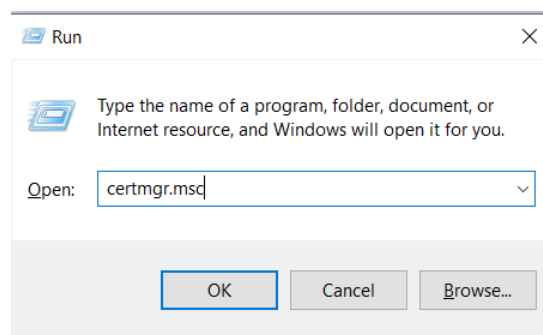

8. This will open the [Certificate Manager window](#). Click on the [Personal folder](#), then click on the [Certificates folder](#). Check if the certificate you installed is on the list.

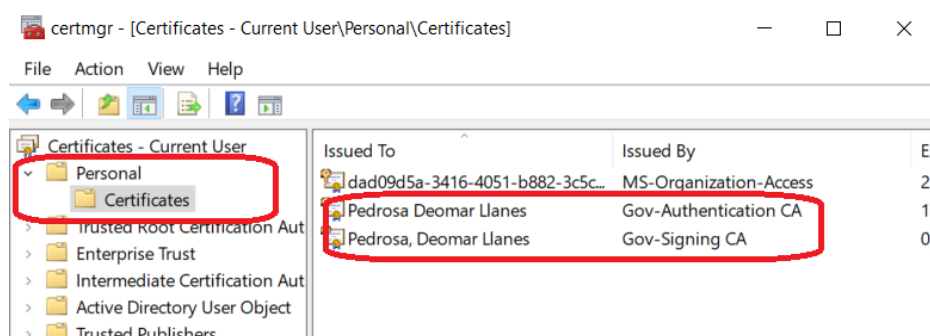

9. Just follow steps 1-8 if you have more certificates that need to be installed into the windows key store.